

HOW TO INSTALL YOUR DECAL

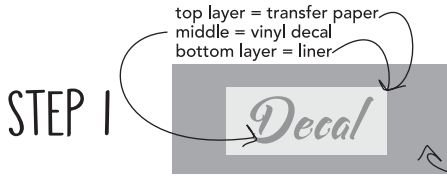

PREP Decals can only be applied to smooth, non-porous materials. Important! Decals will not adhere to the textured lower panels on a snowmobile. Install at room temperature. Remove all dirt, grease and/or wax from the surface before you install your vinyl decal. Caution! Do not use ammonia based cleaners such as Windex.



STEP 1 On a flat surface, use a credit card like a squeegee to press firmly over the whole decal assuring the top transfer layer is properly stuck to the vinyl decal.



STEP 2 Place your decal on the surface that it will be applied to (the decal should still be on the liner with the transfer paper on top). Measure to make sure your decal is properly lined up. Once in place, put a long piece of tape across the entire decal in the center and two small pieces in the corners to hold the decal in place as shown.



STEP 3 On the side of the decal without the corner taped, use the transfer paper to lift the decal off the liner exposing the adhesive side of the decal. Only peel the liner from the decal until you reach the masking tape that crosses the center of the decal. **DO NOT ALLOW THE STICKY PART OF THE DECAL TO TOUCH THE SURFACE YOU ARE APPLYING TO.** Using scissors or a razor, cut away the portion of the liner close to the long piece of masking tape that crosses the decal.



STEP 4 Using your squeegee and starting in the middle where your masking tape crosses the decal, begin to apply the sticky side of the decal to the surface. Use horizontal strokes to apply the decal equally. Continue smoothing out the decal from top to bottom with long horizontal strokes assuring the decal is securely adhered to the surface.



STEP 5 Remove the long piece of masking tape that crossed the middle of the decal. Also remove the small corner pieces of masking tape. Slowly peel the other side of the decal up using the transfer paper to lift it off of the liner, exposing the adhesive side of the decal.



STEP 6 Using your squeegee and starting in the middle where your masking tape crosses the decal, begin to apply the final sticky side of the decal to the surface. Use horizontal strokes to apply the decal equally. Continue smoothing out the decal from top to bottom with long horizontal strokes assuring the decal is securely adhered to the surface.

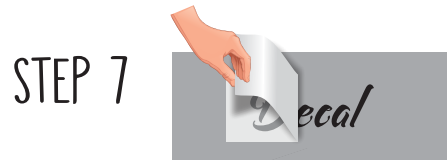

STEP 7 Smooth over the decal with edge of the credit card, assuring the decal is securely adhered to the surface. **SLOWLY** begin peeling the transfer paper off the decal. As you lift, make sure no part of the decal is still attached to the transfer paper. If the decal does start to lift with the transfer paper, simple smooth it back down and firmly go over it again with the edge of the credit card and repeat the transfer paper removal process.



DONE! Now that the transfer paper is removed, do a visual check assuring all the vinyl decal is adhered to the surface. You may see small air bubbles. Most small air bubbles will gas out in a few weeks and disappear. For large air bubbles you can make a small incision into the vinyl with a needle and use a credit card to push the air out.